

**MALL TYPES @ FACTORY AREAS**

- (FOR FACTORY AREA ONLY) INTERIOR & EXTERIOR MALL CONSTRUCTION - CMU TO 7'-4" WITH METAL INSULATED MALL PANELS FROM 7'-4" TO ROOF DECK. SEAL TIGHT.
- (FOR FACTORY AREA ONLY) 8" X 12" NON-CMU MALL FILL. HEIGHT FROM FLOOR TO ROOF DECK. SEAL TIGHT AT ROOF DECK.
- (FOR FACTORY AREA ONLY) 8" CMU WALLS 10'-9" TALL.

**FRONT OFFICE ENLARGED FLOOR PLAN**  
SCALE: 1/8"=1'-0"

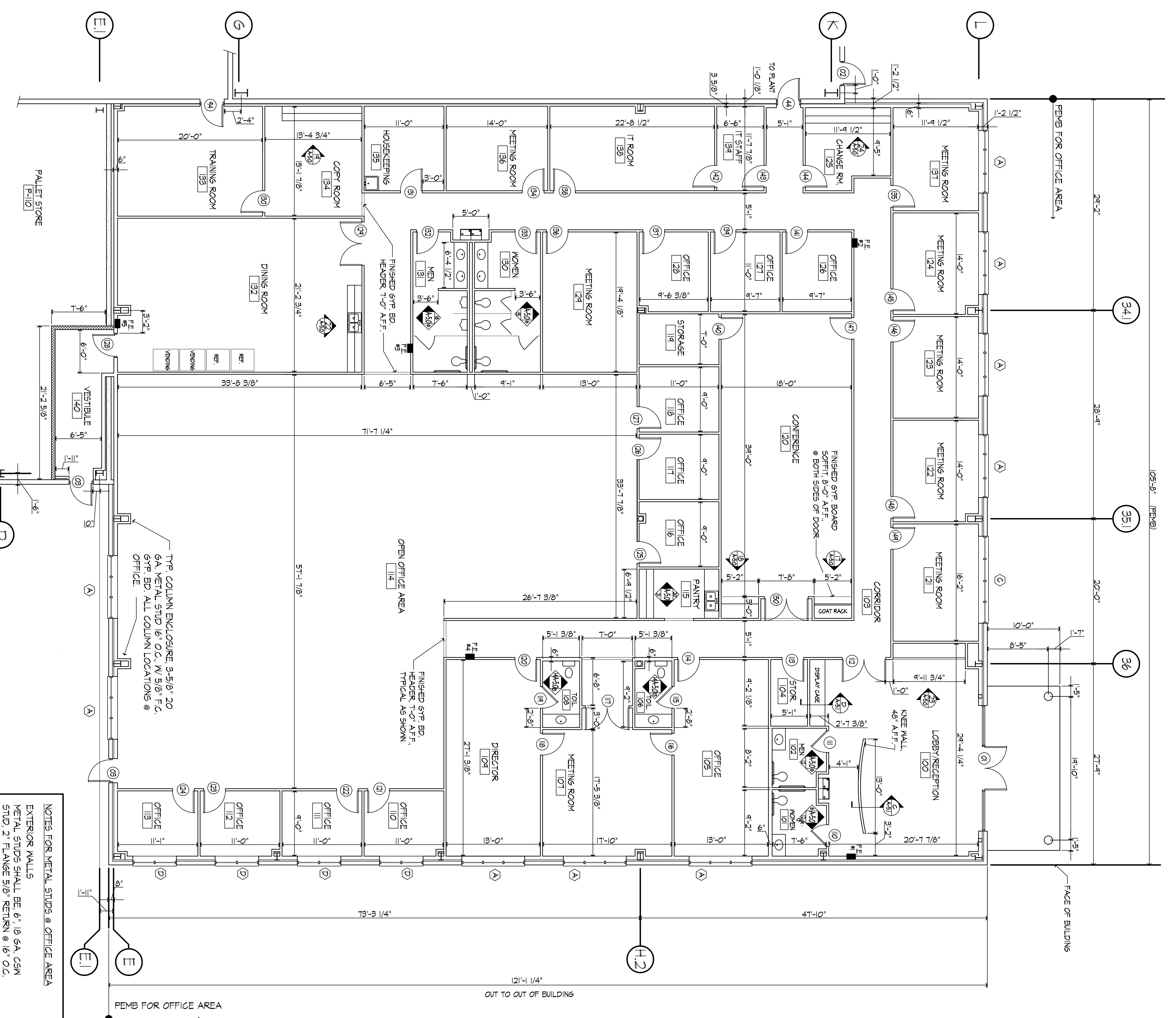

**1-HOUR FIRE-RATED WALL ASSEMBLY**  
CONTINUES TO UNDERSIDE OF ROOF DECK

MP 1200	UL 1465
Construction Type: Gypsum Wallboard Metal Studs One Layer	Thickness: 1 1/4"
5/8" Type X gypsum wallboard or verter board applied at 5/8" edges or parallel to each side of metal studs, 16" o.c. to intermediate studs. Stagger joints 24" o.c. and 12" o.c. to intermediate studs. Stagger joints 24" o.c. each side. (NLS)	Approx. Weight: 6 psf
	Typical Height: 8'-0" to 8'-6"
	Typical Width: 4'-0" to 4'-4"
	Sound Test: NBC 3404 (0-14-10)

**NOTES FOR METAL STUDS @ OFFICE AREA**

EXTERIOR WALLS  
METAL STUDS SHALL BE 6" @ 18 GA. CMU STUD. LANGE 5109. VENTON 18" O.C. TYPICAL.

INTERIOR WALLS  
ALL INTERIOR OFFICE NON-LOADING METAL STUDS SHALL BE 20 GA. LITE STUDS 16" O.C. SEE FLOOR PLAN FOR SPECIFIC SIZE.

**INTERIOR WALL TYPES @ FRONT OFFICE**

- INT. WALL CONSTRUCTION OF 3-5/8" OR 6" @ 20 GA. METAL STUDS WITH 5/8" F.C. GYPSUM BOARD EACH SIDE. FINISHED HEIGHT OF THESE WALLS SHALL BE 12' ABOVE SCHEDULED FINISHED CEILING.
- 1-HR. RATED ULL # 485. INT. WALL CONSTRUCTION OF 6" @ 20 GA. METAL STUDS 16" O.C. WITH 5/8" F.C. GYPSUM BOARD EACH SIDE WITH FILL. SOUND BATT CONTINUES TO THE UNDERSIDE OF ROOF DECK.

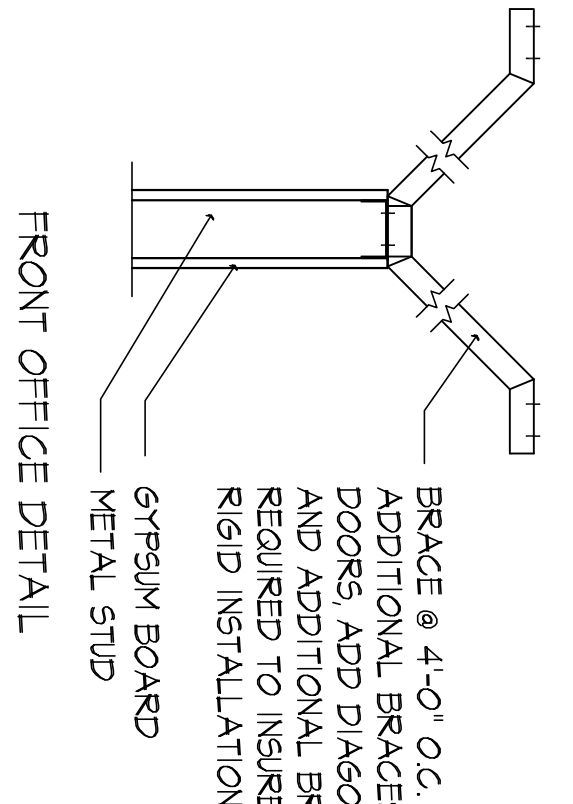

**OFFICE WALL DETAIL**  
SCALE: 1/2"=1'-0"

**ENLARGED OFFICE, TOILETS, PLANT ENTRY AND LABORATORY**

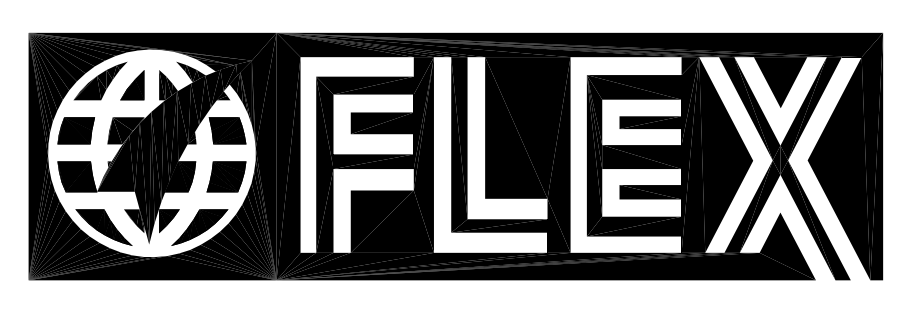

**FLEX FILMS (USA) INC.**  
1221 NORTH BLACK BRANCH ROAD  
ELIZABETHTOWN, KENTUCKY 42702  
PROJECT L-12 BOPET U.S.A.

DATE	REVISION	BY
10-21-11	REVISION NUMBER 1	
1-5-12	REVISION 3 - CMU AND REVISED COLUMNS	

DESIGN DOCUMENTS:  
The design and technical notes are my sole responsibility and liability for problems which arise from failure to follow these plans, specifications and the design intent they convey.

COPYRIGHT © 2011  
This document discloses subject matter considered confidential by FLEX of Kentucky, Inc. and on which FLEX of Kentucky, Inc. has proprietary rights. Neither receipt nor possession thereof confers or transfers any rights to reproduce the document or any part thereof or to disclose any information contained therein or others, or to use it for any purpose without the written permission of FLEX of Kentucky, Inc.

PROJECT NO.	8529-02
DESIGNED BY	MSF/BLL
DRAWN BY	BLL
CHECKED BY	MSF
REVIEWED BY	
DATE	OCT. 2011
SCALE	AS NOTED

**NSC OF KENTUCKY, INC.**

624 Millington Way  
Lexington, KY 40503  
Phone: (859) 223-5644  
Fax: (859) 223-2607  
www.nscflex.com

**UFL-L12 A-1.3**